

THE BOUNDARY SHOWN HEREON HAS BEEN CALCULATED PER THE ALTA/ASCM LAND TITLE SURVEY PREPARED BY COMPASS SURVEYING, LTD. (PROJ. NO. 9508B2, DATE 05-28-08) AS PROVIDED BY CLIENT AND PLACED PER BEST FIT TO THE SURVEY MONUMENTS FOUND IN THE FIELD AT THE TIME OF OUR SURVEY

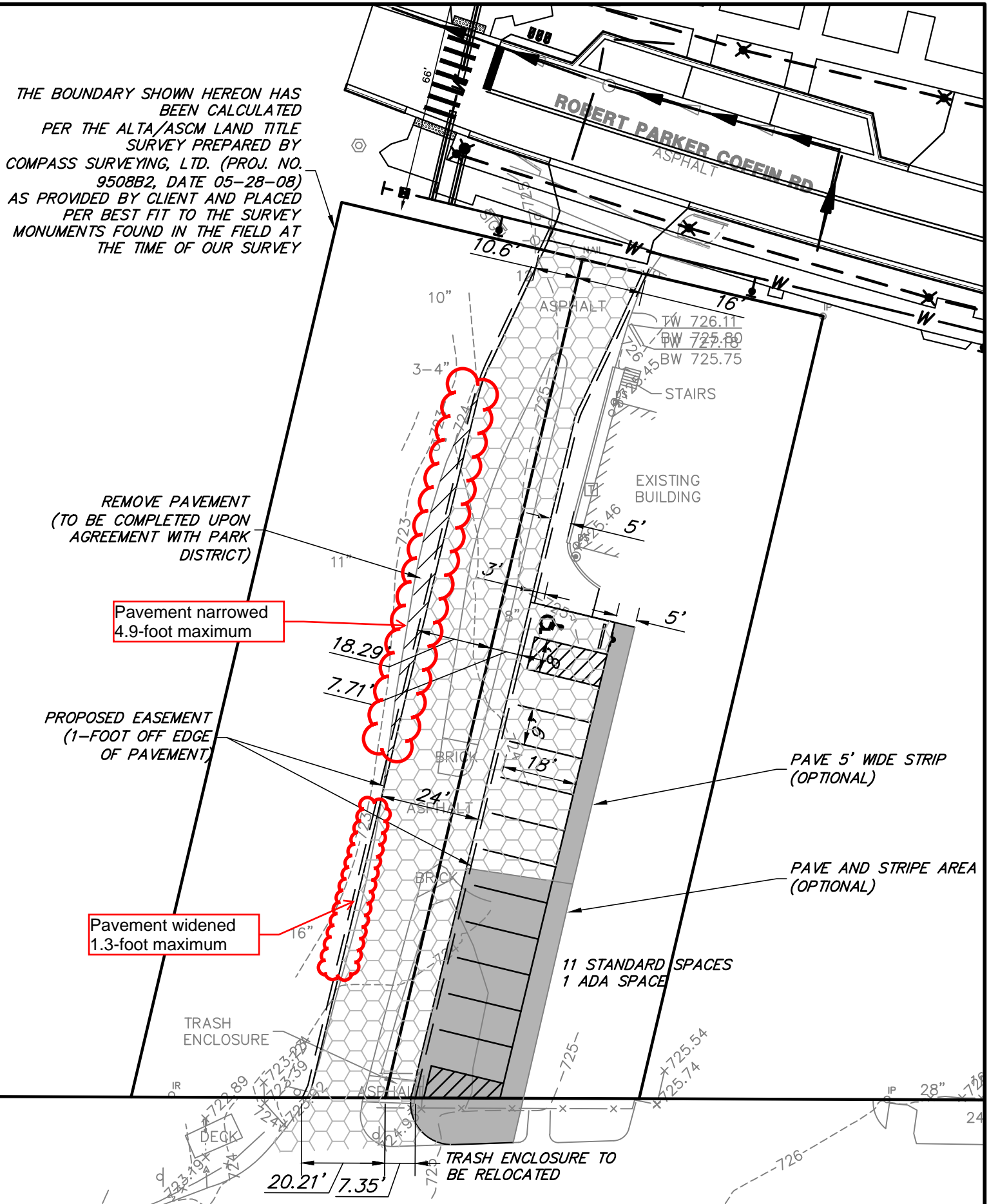

REMOVE PAVEMENT (TO BE COMPLETED UPON AGREEMENT WITH PARK DISTRICT)

Pavement narrowed 4.9-foot maximum

PROPOSED EASEMENT (1-FOOT OFF EDGE OF PAVEMENT)

Pavement widened 1.3-foot maximum

PAVE 5' WIDE STRIP (OPTIONAL)

PAVE AND STRIPE AREA (OPTIONAL)

11 STANDARD SPACES  
1 ADA SPACE

TRASH ENCLOSURE TO BE RELOCATED

G:\5000\5000 LONG GROVE - STEMPLE PARKING LOT SURVEY\5000.306\_7.22.2021 2-WAY ACCESS.DWG 7/27/2021 12:48 PM

**GHA** GEWALT HAMILTON ASSOCIATES, INC.  
www.gha-engineers.com



**TWO-WAY ACCESS EXHIBIT**  
**STEMPEL PARKING LOT IMPROVEMENTS**

Date: 7/27/21

This exhibit is for informational purposes and may not have been prepared for, or be suitable for legal, engineering, or surveying purposes.