

LEGEND

- ▲— EXISTING STORM SEWER
- ▶— PROPOSED STORM SEWER
- ▭ FLARED END SECTION
- SWALES
- CONTOUR
- XXX PROPOSED SPOT ELEVATION

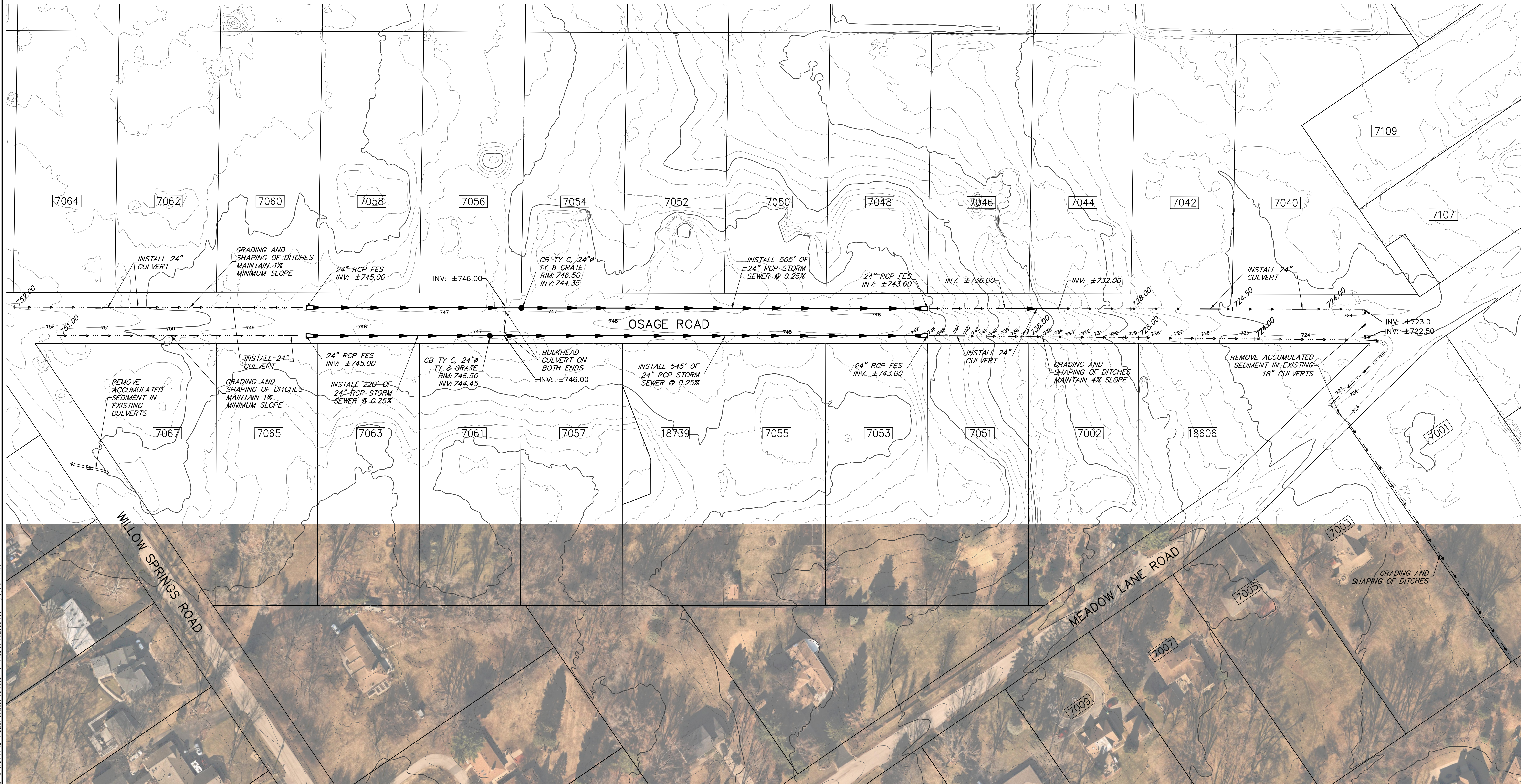
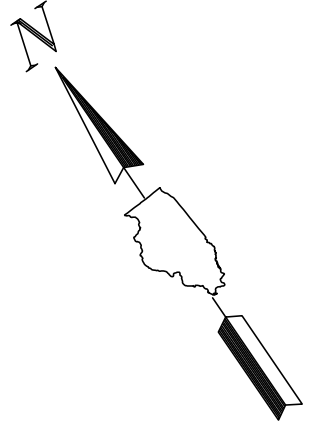
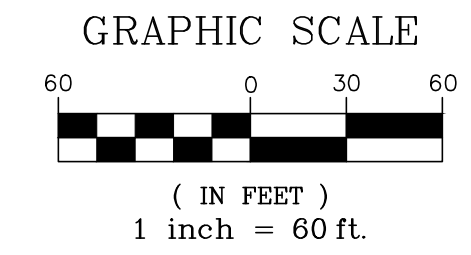

GHA GEWALT HAMILTON ASSOCIATES, INC.
 625 Forest Edge Drive ■ Vernon Hills, IL. 60061
 TEL 847.478.9700 ■ FAX 847.478.9701

COPYRIGHT NOTICE
 This drawing is the property of Gewalt-Hamilton Assoc., Inc. and is not to be used for any purpose other than the specific project and site named herein, and cannot be reproduced in any manner without the express written permission from Gewalt-Hamilton Associates, Inc.

DRAINAGE IMPROVEMENTS EXHIBIT
OSAGE ROAD DRAINAGE IMPROVEMENTS
VILLAGE OF LONG GROVE
LONG GROVE, ILLINOIS 60060

NO.	BY	DATE	REVISION

FILE: 5000.100-PR Towners Drainage.dwg	SHEET NUMBER:
DRAWN BY: BRS	GHA PROJECT #
DATE: 04-13-23	5000.100
CHECKED BY: CLP	SCALE:
DATE: 04-13-23	1" = 60'

OF 1 SHEETS